



*A storage solution to  
retain long items.*





*Long awkward items stored easily.*



# Light Duty Cantilever.

## Your business:

You have products that are lightweight, but are long and awkward and not so easy to store in conventional racking systems. You may want to store them outside your warehouse, while low cost is also a priority.

## Our solution:

Clearspan Light Duty is a cost efficient adjustable cantilever racking system. It is designed for the storage of light, but extra long or awkwardly shaped items. It allows for the optimal use of horizontal space when storing bulky items like crates or long items such as plastic or aluminium extrusions. The system is constructed using Dexion Keylock pallet racking components, so it is very adaptable. Clearspan Light Duty Cantilever can be used both indoors and outdoors or inside cool rooms.

## The vital statistics:

Frame heights	_____	1829mm to 6096mm
Base SE & DE	_____	600mm, 900mm, 1200mm
Arms		
Light duty	_____	450mm & 600mm
Medium duty	_____	600mm & 900mm
Heavy duty	_____	900mm & 1200mm

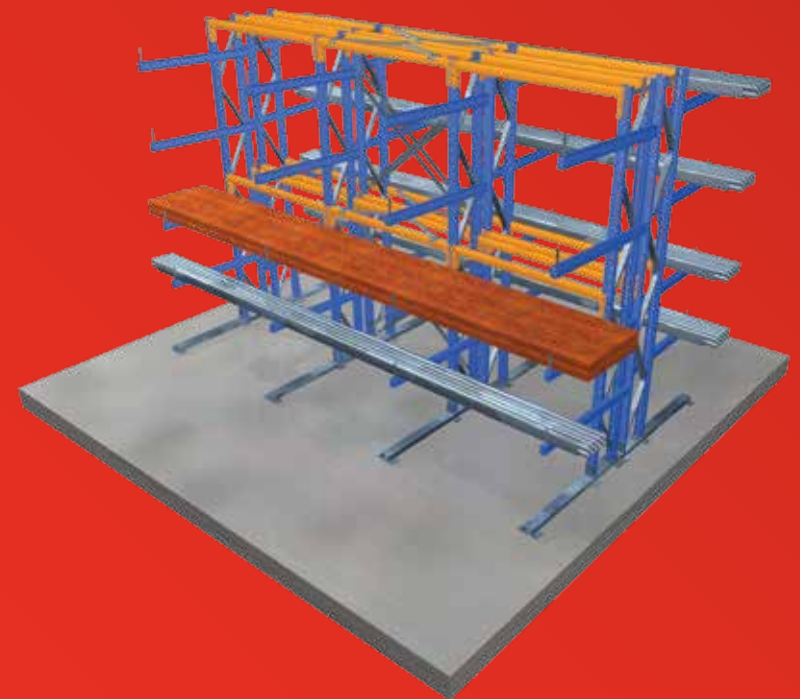

*Spigot ends  
retain  
loose ends.*

Heavy duty arms are fixed to both frame uprights and used in applications where larger, heavier loads need to be stored. Arms are adjusted on 76mm increments.





Makes short work of longer items,



Turnbuckle spine bracing is used for lateral stability. This allows for re-adjustment of the structure should it be required. Frames are made up of two Keylock uprights and are joined together with bolted frame bracing to form a rigid column to support the cantilever arms.



Clearspan Light Duty Cantilever can be loaded using a side loader, conventional forklift truck or by hand.



Plan bracing is used to brace the structure across the horizontal plane.



Light duty and medium duty arms are bolted to the face of the frame uprights and used in applications with light to moderate loads.



Single entry and double entry bases are used to mount the frame and to fix the structure to the ground. The web stiffened base is fixed to the floor with heavy duty mechanical stud anchors.



Hot dip galvanised components are available for use in certified outdoor applications.





The  
short  
and  
the  
long  
of  
it.



# Heavy Duty Cantilever.

## Your business:

You have extra heavy products that are long and awkward to store. You need direct and rapid access to these products, with the ability to store them outside if you desire.

## Our solution:

Clearspan Heavy Duty Cantilever is ideal for extra heavy and extra long items. Clearspan Heavy Duty Cantilever can be used in a variety of industries, aluminium fabricators, steel and timber merchants, plumbing and hardware suppliers, furniture wholesalers and garden suppliers. With no front uprights to impede access, it is particularly suited to accommodating extra long items that can't be palletised. A galvanised option makes it perfect for outdoor applications.

## The vital statistics:

Column	3000mm, 4500mm, 5500mm
Base SE & DE	600mm, 900mm, 1200mm
Arms	600mm, 900mm, 1200mm

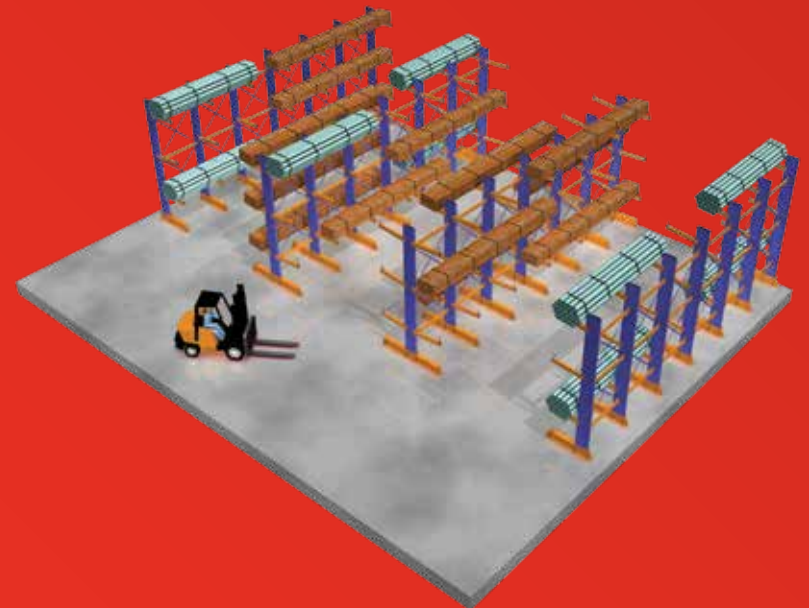

The columns form the backbone of the structure on which the arms are mounted. Arms are adjusted at 100mm increments.

*Apply strong arm tactics.*



# The heavy duty solution for longer items.



The pivoting arm design allows the arm to shift upwards if impact occurs during loading and unloading. This protects the arm above from damage and prevents structural damage to the system.



Arm locking pins are used to restrain the arm onto the column. A lynch pin is used as a safety lock to secure the arm and locking pin to the column.



Optional removable spigot acts as a retaining stop for storage of loose items such as conduit or pipe.



Clearspan Heavy Duty can be loaded using an overhead crane, side loader, or by conventional forklift truck.



Columns are mounted to either single or double entry bases. Bases feature web stiffener plates at key points of concentrated stress. Heavy duty stud anchors provide secure floor fixing.



Turnbuckle bracing provides lateral stability. It also allows for re-adjustment of the structure if required.



Hot dip galvanised components are available for use in outdoor applications.



Anti-sag mesh support.



# Clearspan Heavy Duty and Light Duty Cantilever specifications.



Both Clearspan Light Duty and Heavy Duty can be configured to suit a variety of applications.

## Clearspan Light Duty Cantilever

Specifications	Dimensions
Frame heights	1829mm to 6096mm
Single entry base	600mm, 900mm, 1200mm
Double entry base	600mm, 900mm, 1200mm
50 open beam spacers	914mm, 1067mm, 1219mm, 1372mm, 1524mm (Indoor applications only)
75 open beam spacers	1372mm, 1524mm, 1829mm, 2134mm, 2286mm
Light duty arm lengths	450mm, 600mm (Indoor applications only)
Medium duty arm lengths	600mm, 900mm (Indoor applications only)
Heavy duty arm lengths	900mm, 1200mm

## Clearspan Heavy Duty Cantilever

Specifications	Dimensions
Column heights	3000mm, 4500mm, 5500mm
Column depths	300mm 400mm, 500mm
Single entry base	600mm, 900mm, 1200mm
Double entry base	600mm, 900mm, 1200mm
Arm lengths	600mm, 900mm, 1200mm
Column spacing	900mm, 1200mm, 1500mm, 1800mm, 2100mm

◀ A range of accessories are available; such as deck support brackets to store awkward bulky items such as furniture or white goods; or tube support channels for long materials such as extrusions that bend or sag.

Note: Components available painted or hot dip galvanised for outdoor use, unless specified in the table above. Wind Load Calculations need to be considered in the design of this product for all outdoor applications. Single sided and double sided configurations available.



**Dexion (Australia) Pty Limited. ABN 83 000 083 956. Head Office: 23 Tattersall Road, Kings Park NSW 2148. [dexion.com.au](http://dexion.com.au)  
Dexion New Zealand. Incorp No. 1856839. Head Office: 423 East Tamaki Road, East Tamaki, Auckland 2013. [dexion.co.nz](http://dexion.co.nz)**

Whilst the utmost care is taken to ensure the accuracy of the information contained herein, it is provided in the understanding that the company shall under no circumstances be liable for any injuries, expenses or other losses which may in any way be attributable to the use or adoption of such data and/or design details. All dimensions indicated are nominal only. Dexion reserves the right to alter or amend without prior notice data and design details specified herein. Product specifications may vary between regions. Re-Order Code M070. F-S-A/DEX0145

